

GETTING STARTED WITH KEY LIGHT AIR



OSRAM

LEDs
Included



reddot winner 2020

elgato 



KEY LIGHT AIR

SETTING UP KEY LIGHT AIR

1

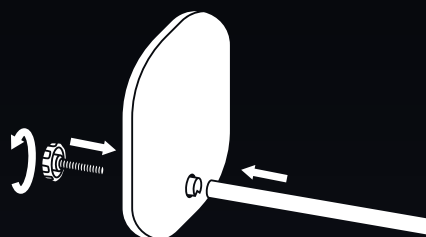

Secure the pole to the base using the included screw.

2

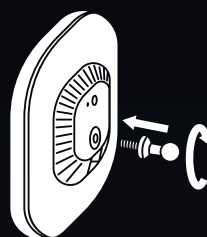

Screw the ball mount into the threaded socket on Key Light Air.

3

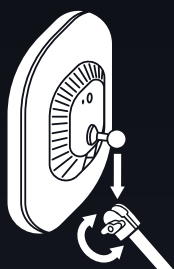

Insert the pole into the ball mount socket and tighten the knob.

4

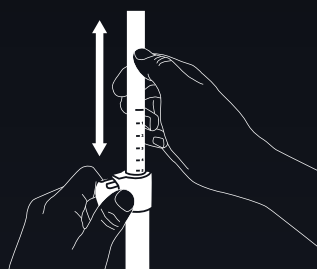

Loosen the screw to adjust the length.

5

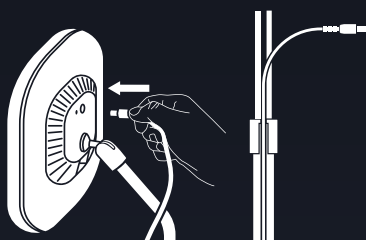

Connect the power supply and run the cable through the clip and rail.

6

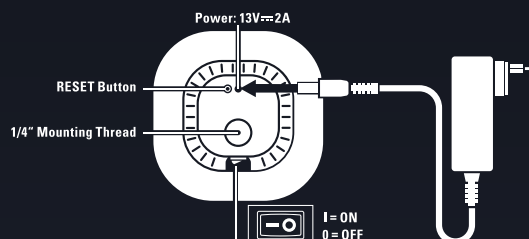

Insert the power plug into the back of Key Light Air, and the larger power brick into your nearest wall socket.

CONTROLLING KEY LIGHT AIR

Key Light Air is controlled via Wi-Fi from a PC, Mac, Android or iOS device.

If your PC or Mac is not equipped with Wi-Fi, use the Elgato Control Center app on your iOS or Android device to add Key Light Air.

A Wi-Fi connection is only needed for initial pairing. Once paired, you can control Key Light Air via any wired or wireless device in your network.

PC/Mac setup



Download and install the Elgato Control Center Software - elgato.com/download

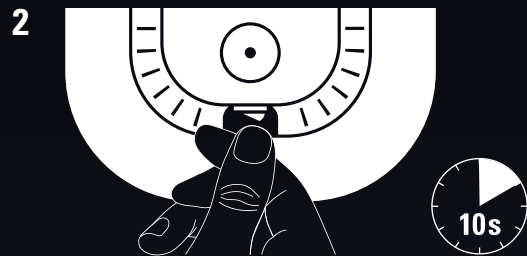

Switch on your Key Light Air. It will take approximately 10 seconds to boot up.

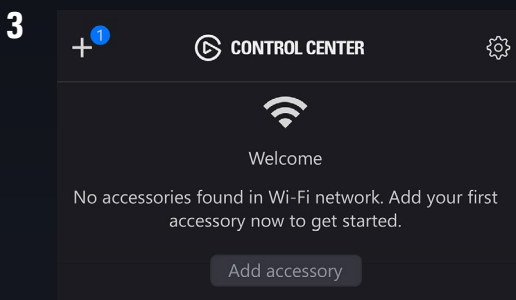

Launch Control Center and pair Key Light Air by clicking the + icon.

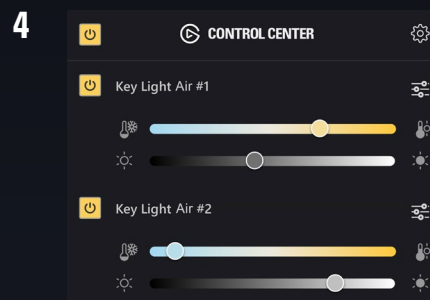

Use Control Center to switch Key Light Air on/off, adjust brightness, and finetune color temperature.

Resetting Key Light Air

Power on Key Light Air. Push and hold the RESET button for at least 10 seconds until the light flashes 3x.

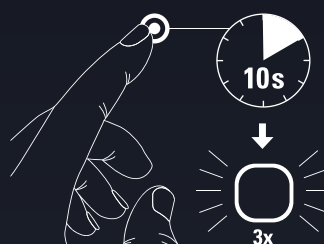

Compatible with:



POSITIONING KEY LIGHT AIR

To get the most out of your new lighting accessories, we recommend a few different ways to set them up.



When using a single Key Light Air as an additional light source, you can position it alongside your other light source to eliminate shadows on your face. If Key Light Air is your primary light source, position it directly in front of you, just above your eyeline, angled downward at approximately 30 degrees. This lighting method creates a dramatic yet professional look.



When using more than one Key Light Air, position them on either side of your desk or workspace, and have the light sources aimed at your face at about a 45-degree angle. This is the best way to properly illuminate a green screen or wall that is behind you, and eliminate shadows that would be created by a single light source. Key Light Air features adjustable brightness and color temperature, so you can set ideal lighting conditions for your setup.