

What's in the box:

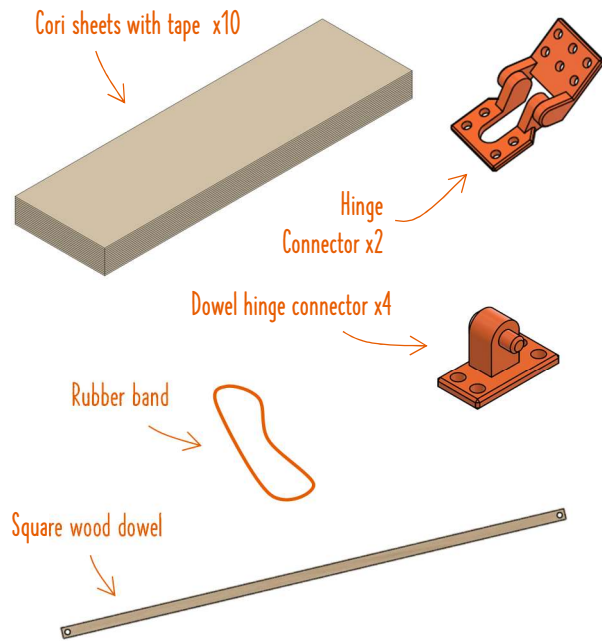

What's not in the box:

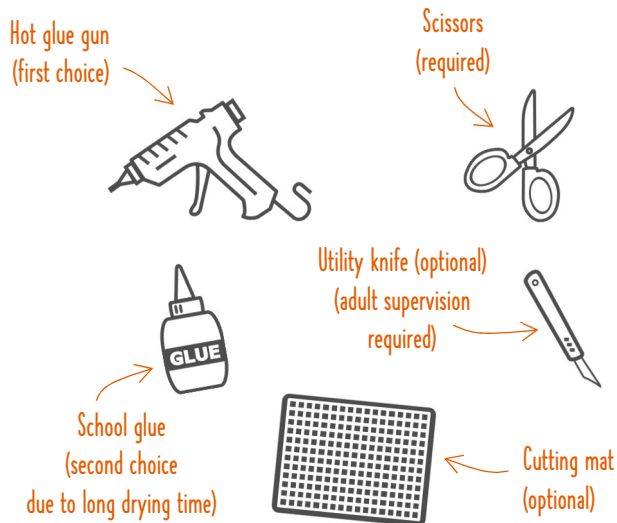

STEP 1: Build the main structure

Cut Cori sheets to the dimensions shown and fold them into beams. Next, glue the beams to form the structure shown.

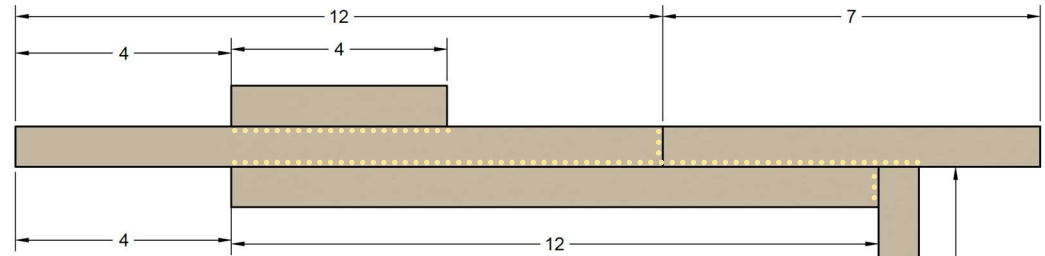

STEP 2: Add the hinged lower jaw

Cut and fold another 4" Cori beam and use a Cori hinge to connect it to the main structure from step 1 with glue. It is important to **ONLY** glue this beam to the hinge and not to the other beams, so it can pivot freely.

Dotted yellow lines indicates glue

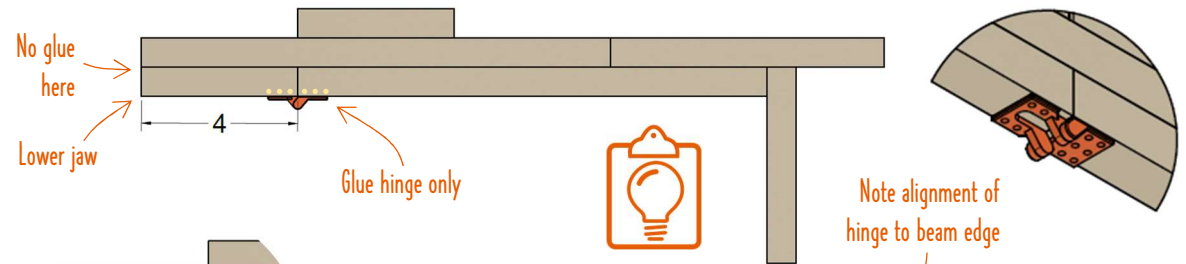

Lower jaw should move freely

STEP 3: Prepare hinged trigger

Cut and fold another 4" Cori beam and glue the second hinge to the top edge as shown to the right. Pay close attention to the exact location of the hinge.

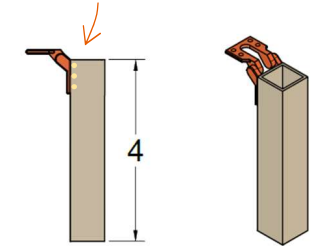

STEP 4: Add hinged trigger

Glue the hinge from step 3 to the main structure from step 2, as shown above.

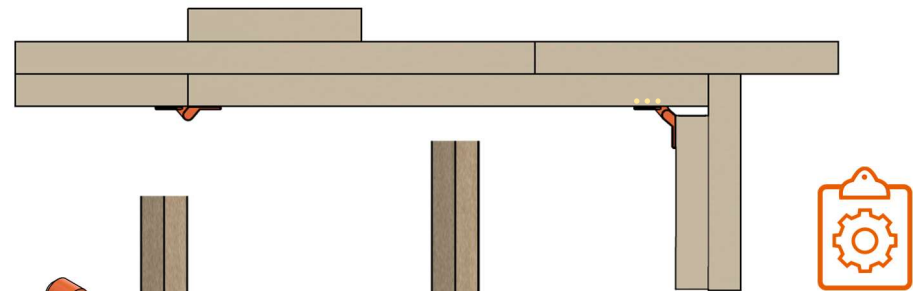

STEP 5: Prepare linkage

Assemble the four dowel hinge connectors onto both ends of the square dowel. Hold them in place as you glue them to the beams in the following step.

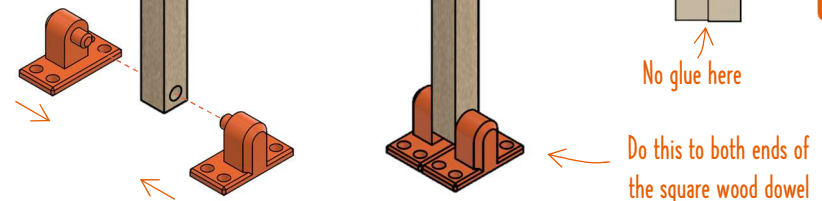

STEP 6: Complete the main structure

Glue the linkage from step 5 between the lower jaw and the trigger as shown. Double loop the rubber band and place it over the jaws. Your structure should now be functional. Squeeze the trigger and make sure the jaw opens.

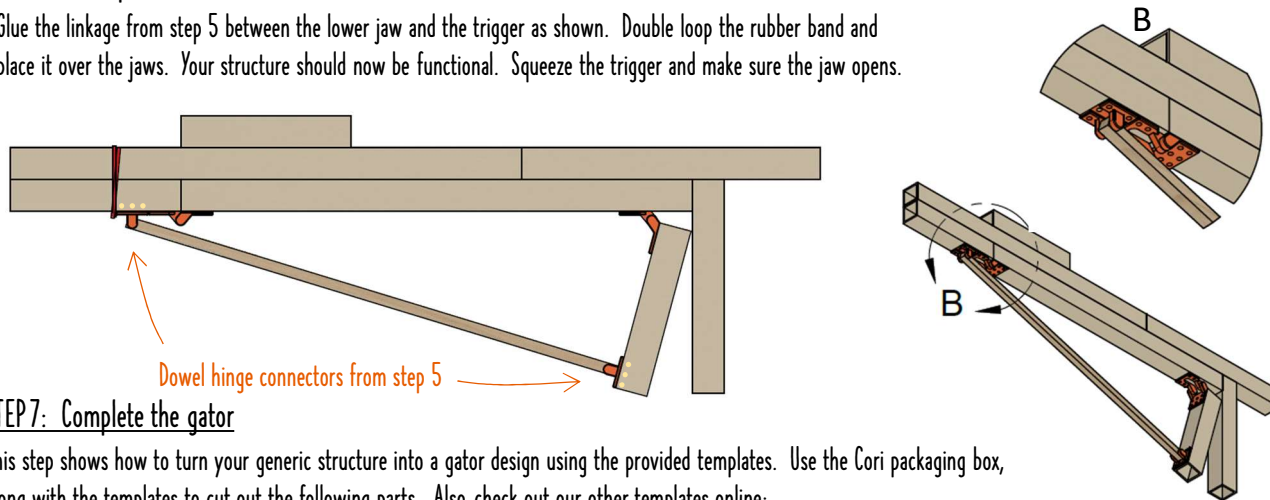

STEP 7: Complete the gator

This step shows how to turn your generic structure into a gator design using the provided templates. Use the Cori packaging box, along with the templates to cut out the following parts. Also, check out our other templates online: <https://coricreate.com/pages/coriculum>. Or, better yet, come up with your very own design of your favorite animal. Now is the time to make it uniquely yours by adding paint, stickers, and any other material that you have. Unleash your creativity!

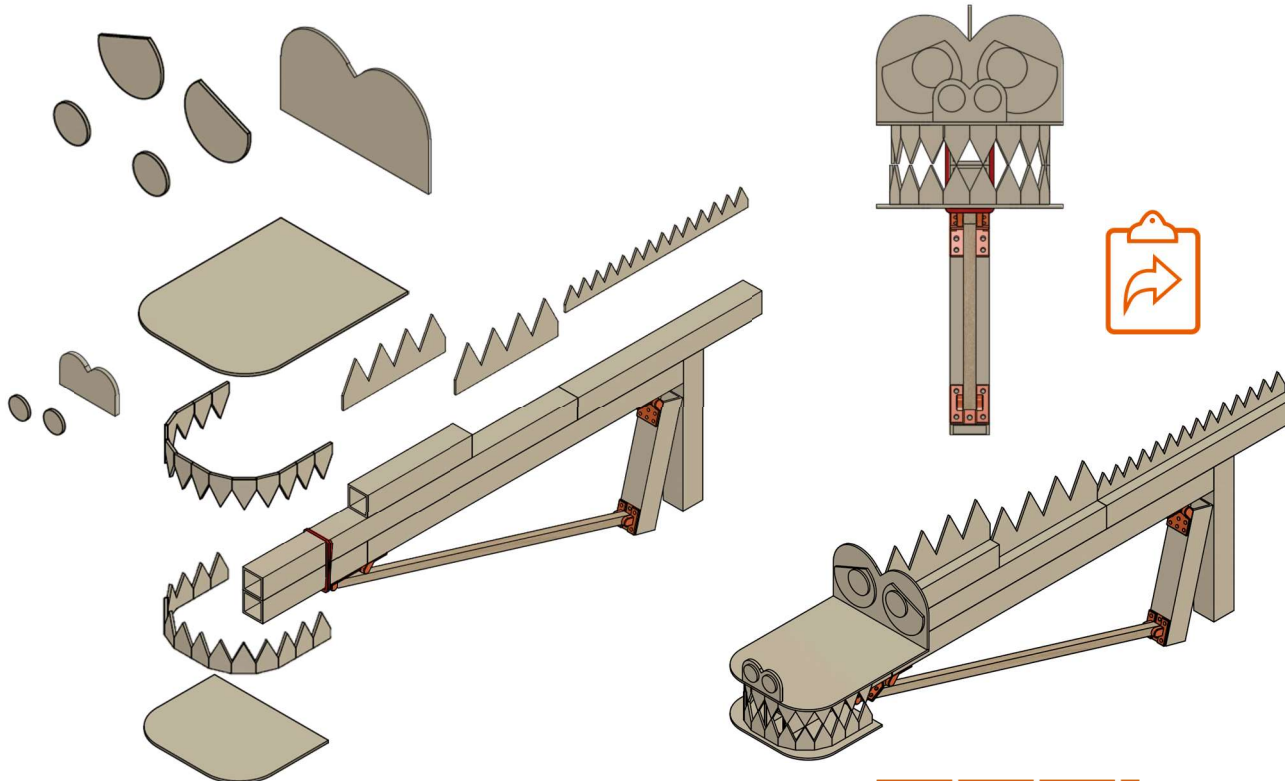

Gator

Instructions

Unleashing creativity

Empower the innovator in any maker while applying real practical STEM skills. The Cori Gator kit is the perfect project to seed curiosity, build grit, improve spatial skills, and sharpen problem solving abilities.

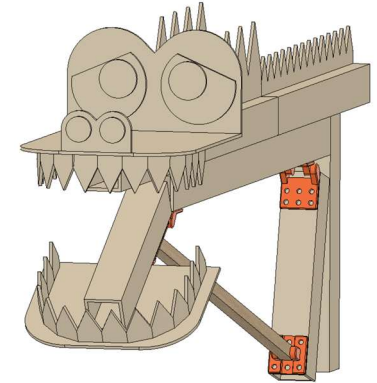

Get a coach

At Cori, we believe in the value of having a coach or a mentor. Every time you see a coach's pad icon in the instructions, it is a good time to check in with your chosen coach.

Coach's pad →



Measure twice, cut once

You will construct this model from the ground up. Careful measurements, cutting, and gluing are required to complete this build. While detailed step-by-step instructions are provided, we highly encourage you to improvise and modify as you please. You may even choose to incorporate other materials along the way. But most importantly, have fun!



1-2 hours



Grit required



Ages 8+
(5+ with adult)

CORI

www.coricreate.com